

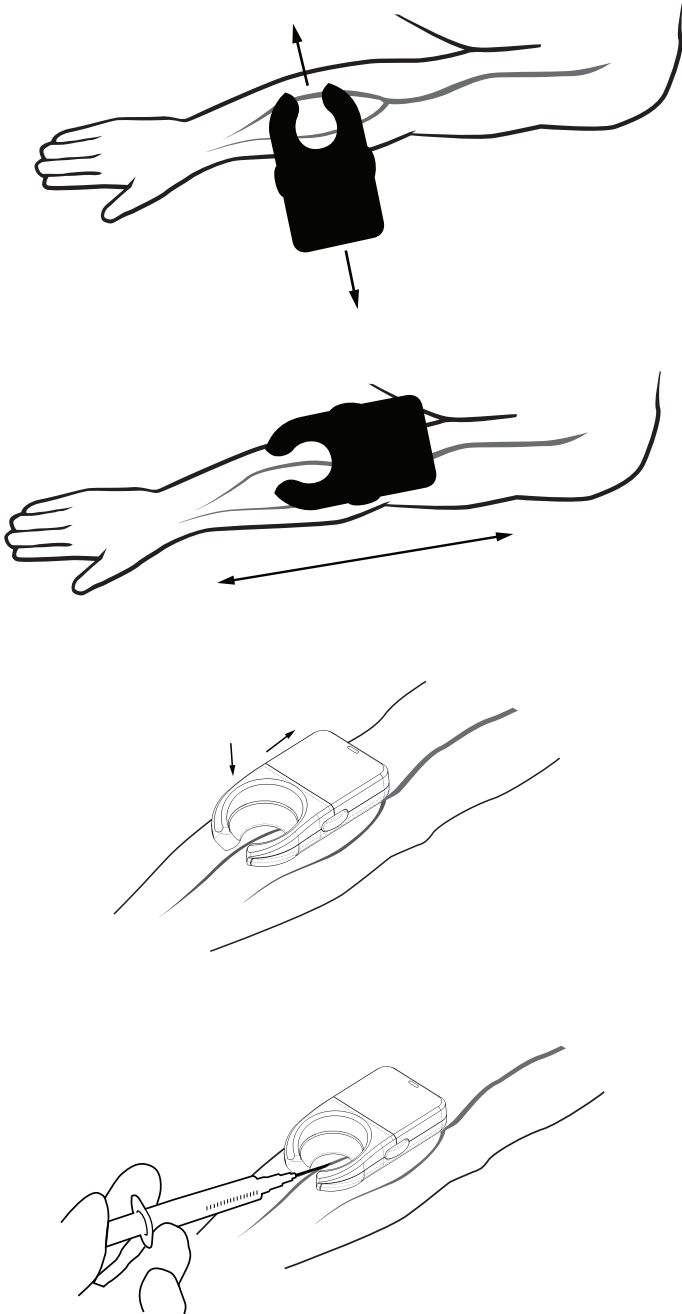

Veinlite Quick Guide



1

FIND THE VEIN

To scan for veins, place device **DIRECTLY** on the skin, perpendicular to vein direction. Scan side to side. Veins will be visible as dark lines due to transillumination

2

IDENTIFY THE VEIN

Once a suitable vein has been identified, rotate Veinlite 90 degrees, parallel to the vein.

3

SECURE THE VEIN

gently apply pressure on the unit and push back to anchor the vein. This provides traction to the skin.

4

ACCESS THE VEIN

Insert the needle into the vein, through the opening of the Veinlite.